



M
MATISON
ENTERPRISE

ripo
www.ripo.lv

KITCHENS



Contacts:
Matison Enterprise AB
Hammarby Sjöstad
Ljusslingan 4,
120 31 Stockholm
+46 72 331 4157

info@matison.se
www.matison.se

Table of contents

About RIPO	3
Kitchen Integra	5
Kitchen Classic	9
Kitchen Modern	13
Kitchen facades and materials	17
Kitchen furniture arrangement types	23
Ergonomics in kitchen	25
Kitchen cabinets	33
Wall panels	39
Worktops	45
Kitchen furniture equipment	51
Handles	57
Home appliances	61
Designing	63
Production, delivery and montage	65
Tips from RIPO	68



Experience. Design. Quality.

RIPO is one of the leading Latvian companies that, according to individual orders, designs and manufactures a wide range of products for home improvement. The high quality of the products offered by RIPO is making the brand stand out. A wide assortment of products is suitable for anyone who wants to arrange their home with excellent design and quality solutions. RIPO offers both building materials and decorative finishes, as well as sophisticated, elegant furniture and a wide range of interior elements.





Integra
kitchen furniture



Classic
kitchen furniture



Modern
kitchen furniture



Facade: melamine, hickory 02.89

Worktop: artificial stone, black

Facade: acrylic, white 02.01

Kitchen Integra

Integra

Kitchen furniture series Integra combines the perfect congeneric design. The use of advanced materials and technologies, which bring the functionality, ergonomics, practicality and elegance in the kitchen. The beauty of Integra is the invisible flow handles which are embedded in the profiles. This series consists of smooth planes, simple shapes and practical, elegant materials. Every furniture in this series features an efficient and thought-out organization of drawers, baskets, shelves, dividers and other equipment. Kitchens Integra are an expressive and highly thoughtful design suitable for true lovers of sophistication. Cooperating with RIPO designers, the customer's intentions are realized, which results in a great set of kitchen furniture. The kitchen should be not only practical and functional, but also beautiful and elegant.





Facade: melamine, alabaster 02.51

Plastic wall panel

Worktop: artificial stone, galaxy mist 311A

Facade: natural oak, veneered 05.92

Kitchen Integra

Kitchen Integra measurements

Base units

W 300/400/500/600/700/800/900/1000
 H 780 without plinth
 D 590

Tall units

W 300/600
 H 1320/1680/1860/2040/2220 without plinth
 D 590

Wall units

W 300/400/500/600/700/800/900/1000/1100/1200
 H 360/540/720/900
 D 360

Side panels

T 18/25

Plinth

H 100/150

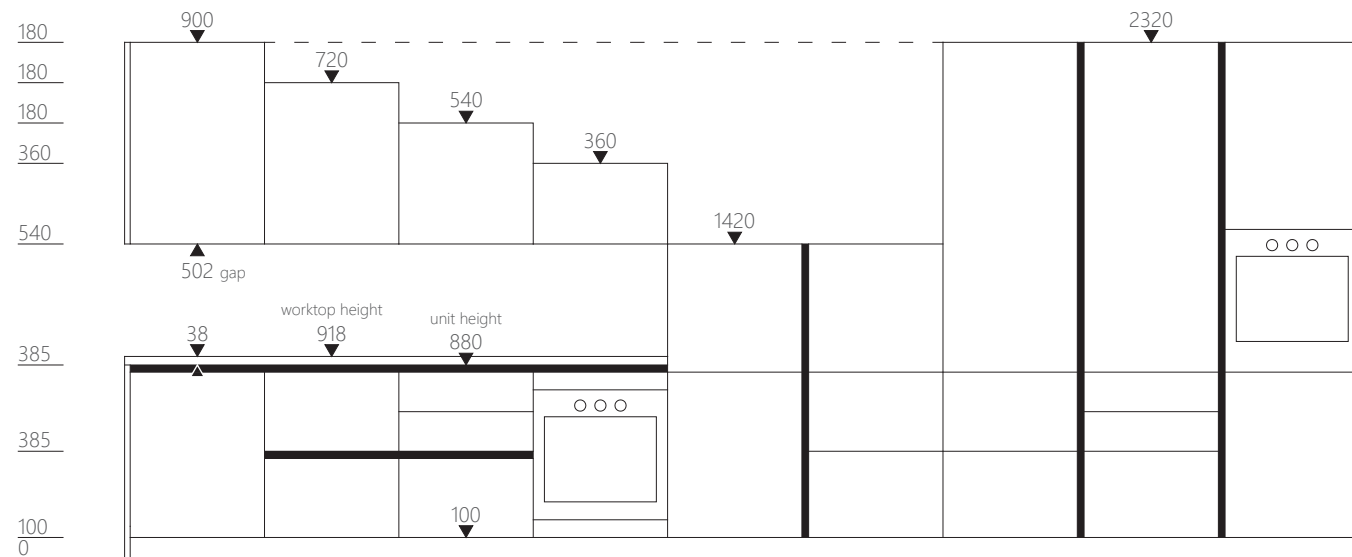
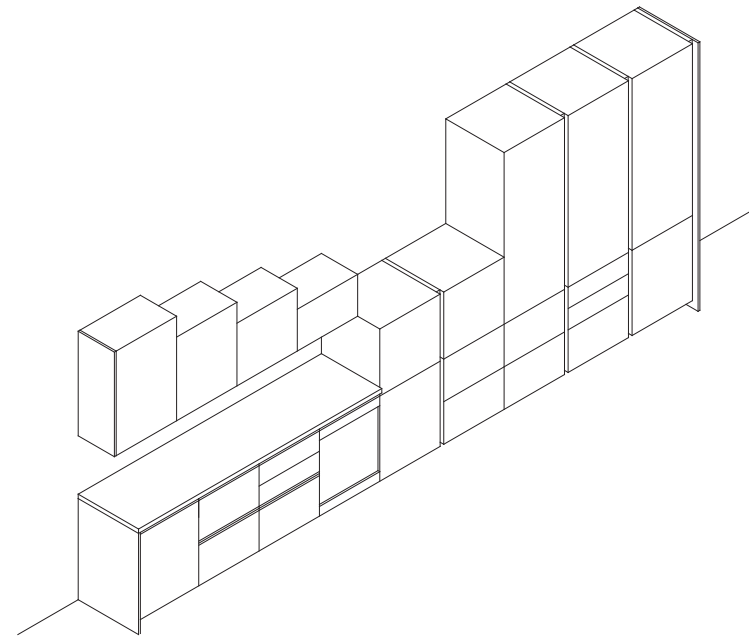



KINGS CROSS ST.
RUSSELL SQUARE
HOLBORN
COVENT GARDEN
LEICESTER SQUARE
PICCADILLY CIRCUS
GREEN PARK
HYDE PARK CORNER
KNIGHTSBRIDGE
SOUTH KENSINGTON
GLOUCESTER ROAD
EARLS COURT

LEYTONS
LEYTONSTONE
PLAISTOW
STRATFORD
VICTORIA
WALTHAMSTOW
WALTHAMSTOW
WATERLOO
WEST HAM
WHIPPS CROSS

Facade: MDF, colour NCS S2005-Y40R

Worktop: artificial stone

Handle: RO 049

Kitchen Classic

Classic

The kitchen Classic furniture range is typical of classic design features, which are perfectly combined with contemporary and modern design trends. Modern classics do not have a strict border, so the design options are as unlimited as possible. Nowadays, kitchens Classic are becoming more desired, as they are combined with modern style elements. Kitchen Classic furniture features moulded lines in the facade, cornices, and classic-style panels. Kitchen Classic solutions are equally practical and majestic. They can integrate the diverse application of materials and equipment, that highlights individuality. Cooperating with RIPO designers, the customer's intentions are realized, which results in a great set of kitchen furniture.





Kitchen Classic measurements

Base units

W 300/400/500/600/700/800/900/1000
 H 720 without plinth
 D 580

Tall units

W 300/600
 H 1260/1620/1800/1980/2160 without plinth
 D 580

Wall unit

W 300/400/500/600/700/800/900/1000/1100/1200
 H 360/540/720/900
 D 360

Side panels

T 25/50

Plinth

H 150/100

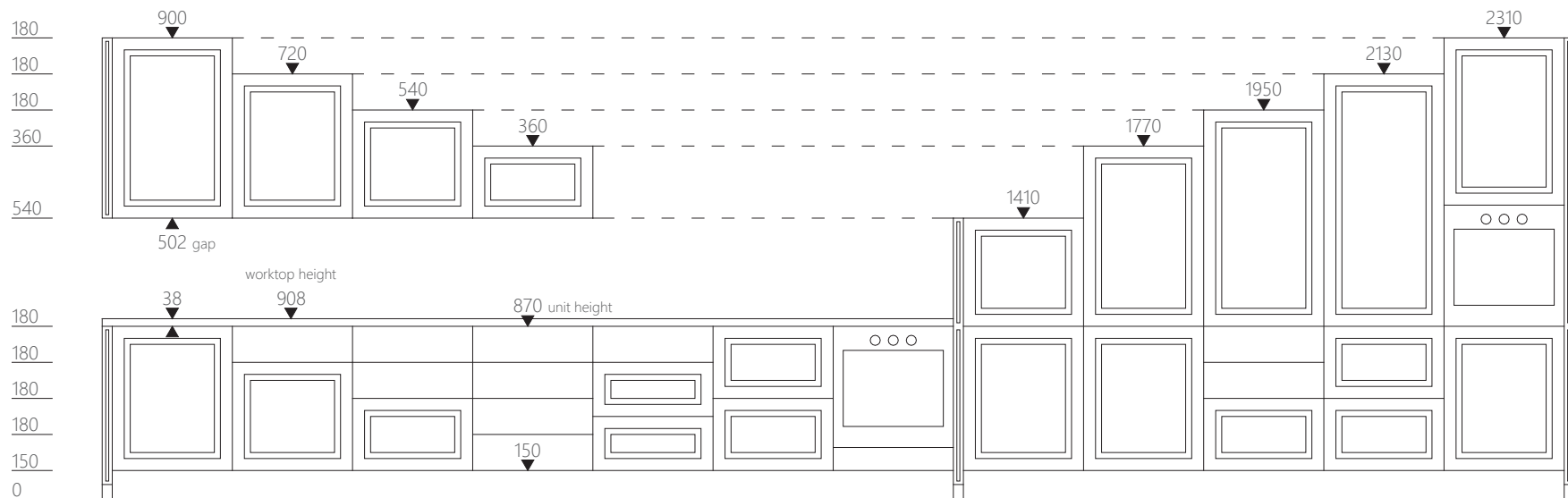
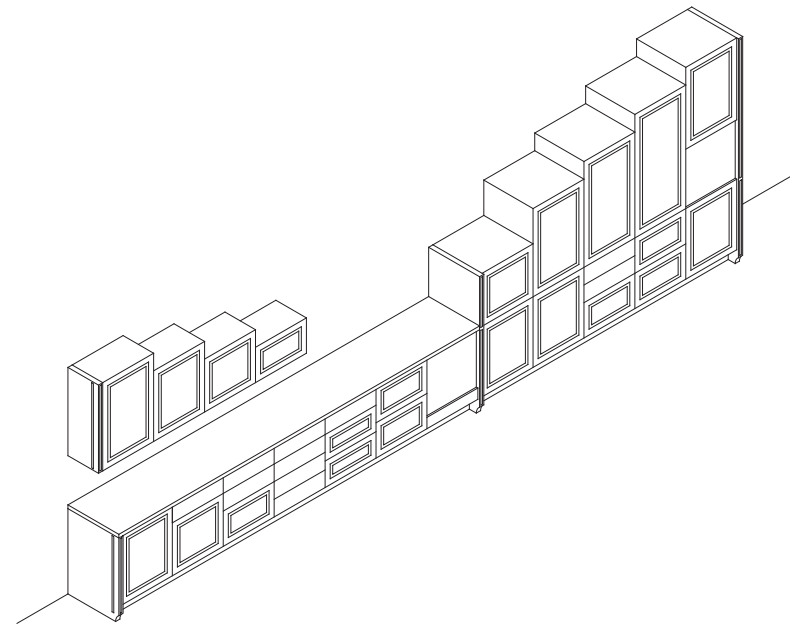



Handle: RO 036-320

Worktop: melamine, H1180 ST37 Natural Halifax Oak

Facade: melamine, premium white 02.49

Kitchen Modern

Modern

Kitchen Modern furniture features a clear line, smooth surfaces, precise detail and laconic shapes that gives light, cleanliness and space in the room. They create an easily perceptible composition of the kitchen, where calm tones - white, black, brown, grey, beige etc.- mainly dominate. Inside of this furniture line are functional shelves, drawers, pull-out baskets, well-structured and thought-out storage systems. Kitchen Modern furniture is elegant and at the same time a practical choice. Cooperating with RIPO designers, the customer's intentions are realized, which results in a great set of kitchen furniture. Kitchen should be not only practical and functional, but also majestic and harmonious.





Facade: melamine, graphite 02.21

Handle: RO 049

Plinth: melamine, graphite 02.21

Facade: acrylic, white 02.01

Worktop: melamine, F222 ST87 Tessina Terra

Kitchen Modern

Kitchen Modern measurements

Base units

W 300/400/500/600/700/800/900/1000
 H 720 without plinth
 D 580

Tall units

W 300/600
 H 1260/1620/1800/1980/2160 without plinth
 D 580

Wall unit

W 300/400/500/600/700/800/900/1000/1100/1200
 H 360/540/720/900
 D 360

Side panels

T 18/25

Plinth

H 150/100

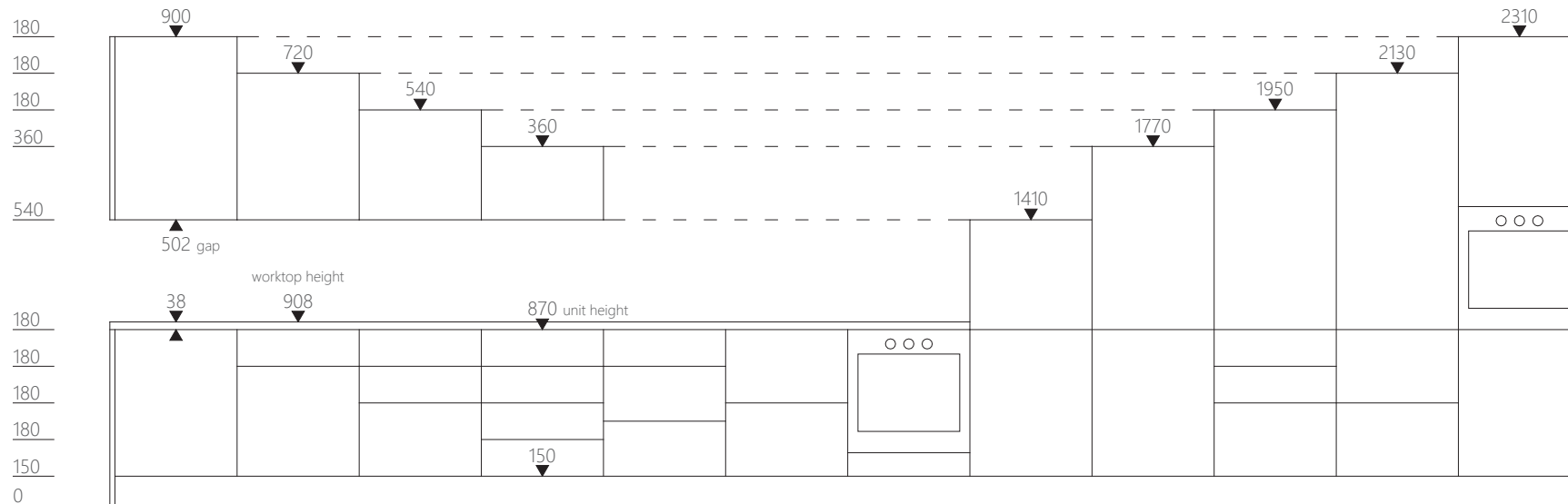
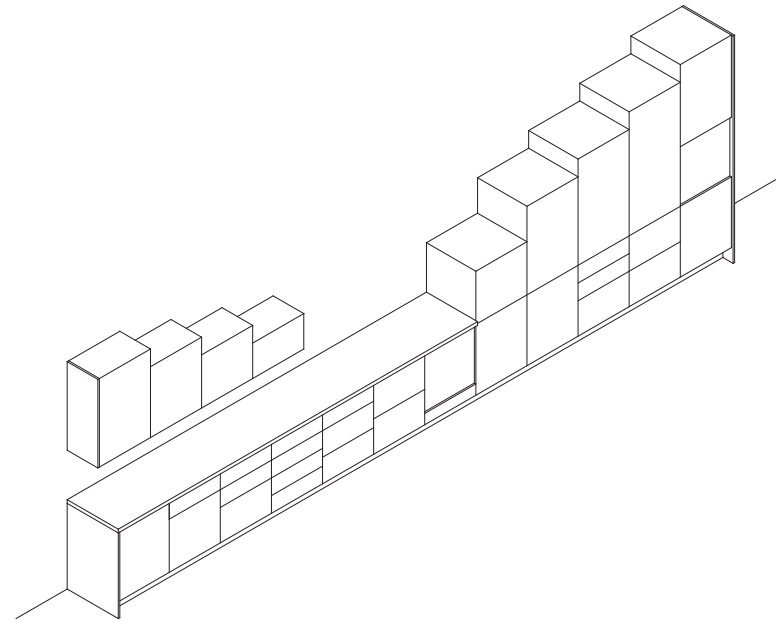



Worktop: melamine, H3309 ST28 Sand Gladstone Oak

Facade: melamine, U702 ST9 Cashmere Grey

Facade is the main furniture element - the higher the quality, the more functional and aesthetic solution. Furthermore, furniture lifetime is longer.

Facades

The appearance and service of kitchen furniture mainly depends on the materials used. RIPO offers a wide range of materials, to produce all types of kitchen furniture. The most visible parts of the kitchen are the facades of the cabinets. Their appearance and design determine the overall mood of the kitchen, accentuate a part of the kitchen or, on the contrary, bring harmony. The factors that should be considered when choosing a facade type includes things like the material, appearance, practicality, colour combinations and specifics of care. The offer includes a variety of acrylic facades, aluminium frame fronts, painted MDF facades and painted MDF facades with glass.

Melamine facades

Melamine is the most widely used material in furniture and facades. Melamine facades have a large range of modern colour combination and textures. The melamine facades are easy to maintain, the surface is scratch-resistant and durable.



Melamine

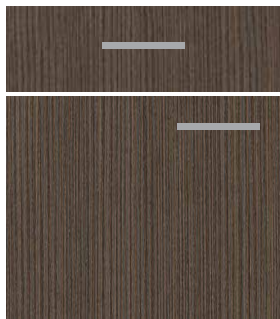

02.15 Venge	02.17 Larch premium white	02.18 Larch black	02.19 Acacia	02.20 Oak ferrara	02.21 Graphite
02.22 Stone gray	02.23 Gray	02.24 Cubanit gray	02.25 White	02.26 Maple	02.29 Onix gray
02.30 Light gray concrete	02.32 Ferro bronze	02.33 Elm tossini	02.34 Titanium	02.38 Brown Charleston oak	02.40 Stainless steel
02.41 Linen beige	02.42 Pigeon gray	02.43 Cashmere	02.44 Truffle	02.45 Saffron	02.46 Caramel
02.47 Wasabi	02.49 Premium white	02.50 Ares stone	02.51 Alabaster	02.54 Matrix gray oak	02.55 Oak tranche
02.56 Gray glossy	02.60 Pine cream	02.62 Oak Gladstone	02.64 Oak nabucco	02.65 Oak Gladstone sepia	02.67 Cappuccino glossy
02.68 Beige glossy	02.69 White glossy	02.70 Penelope bronze	02.71 Matrix dark oak	02.73 Oak black thermo	02.80 Light blue
02.81 Dark pink	02.87 Black Havana pine	02.88 Natural Corbridge oak	02.89 Natural hickory	02.90 Maple mandala	02.96 Sand gray
02.97 Congo					

Acrylic facades

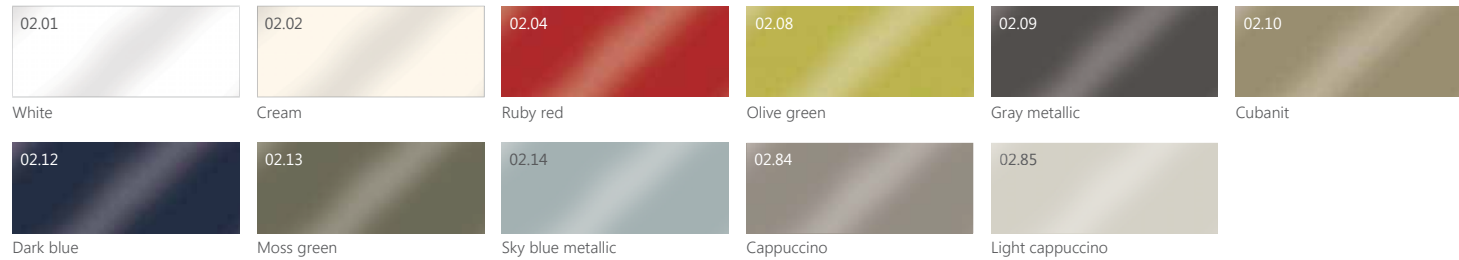

Acrylic facades have a bright surface, they are smooth and glossy. The material is made on a KSP or MDF-based material, with an acrylic top layer, which also defines the appearance of the product. Acrylic facades, with a mirror-like surface, are one of the main visual accents of the kitchen. Acrylic materials are available in a variety of colours, and their combination with other materials for a common kitchen design. Thanks to the big reflection, they create mirror effect, there the light can reflect and make beautiful visual effects. The biggest drawback of acrylic is the possibility of scratching. Acrylic facades should be cut and treated.

Veneered facades

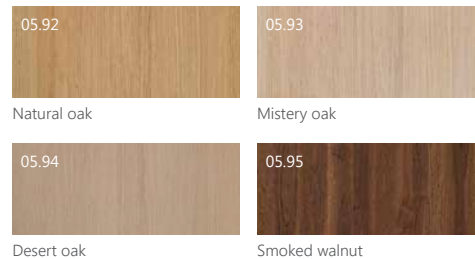

Painted MDF facades

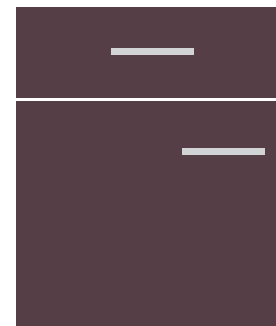

MDF facades can be painted in any NCS colour.



Facade: melamine, premium white 02.49

Glass wall panel

Handle: RO 005

Kitchen Modern



Deco materials

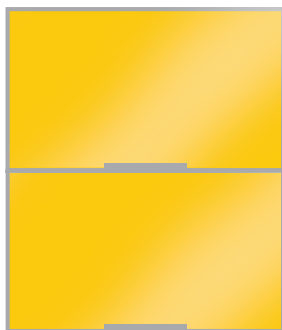

Facades with glass in aluminium frame

Such facades are easily assembled with a variety of glass fillings - decorative glasses, glass with semi-transparent structures or glass with coloured Deco films. Facades with glass are one of the most popular ones. They are easy to process and paint in any NCS colour palette. They are also easy to maintain and are scratch resistant.

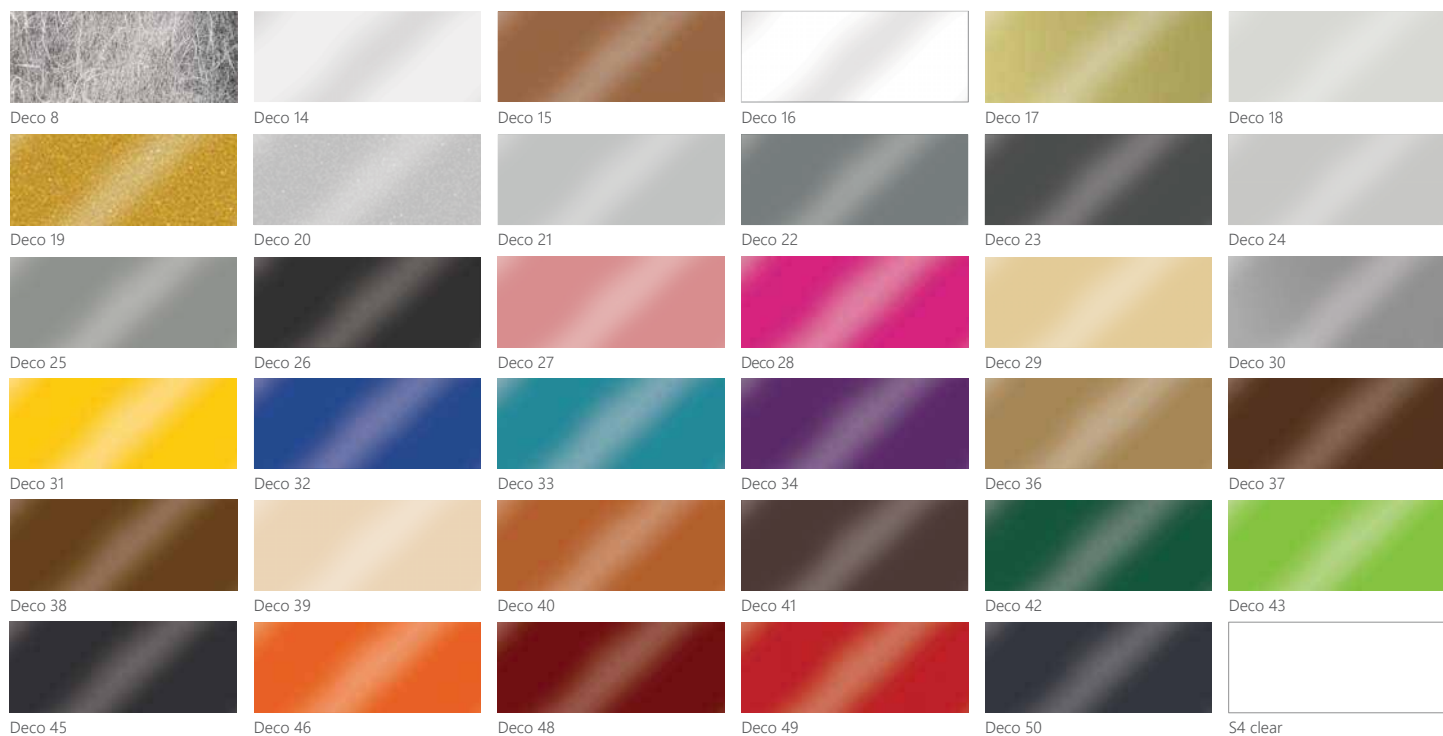



Facade: melamine, venge 02.15

Facade: melamine, premium white 02.49

Handle: RO 005

Kitchen Modern

Kitchen furniture arrangement types

L-type arrangement for small, square kitchens.

The kitchen position in one row is suitable if the kitchen space is small or if the kitchen is combined with the living room. This way, there may be a working area on one side of the space, and the other is a rest area.

The layout in two rows is suitable solution for long, narrow kitchens, with a window at one end and a door at the other end.

U-shaped furniture is located along three walls. For such a solution, the space should not be too large, because the range of motion can be too wide, therefore inconvenient. The recommended end wall width is at least 2,5 meters.

Having half island kitchen provides the furniture position with additional raised work, hob, cabinet or sink surface. This way, it is also possible to separate, for example, the work area from the seating area.

The kitchen with an island provides with an additional structure in the centre. This type of kitchen is suitable only for large rooms or dwellings, where the kitchen with the living room is one room.

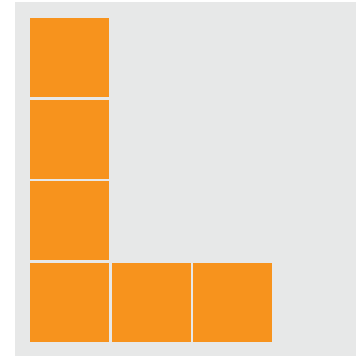

L type arrangement

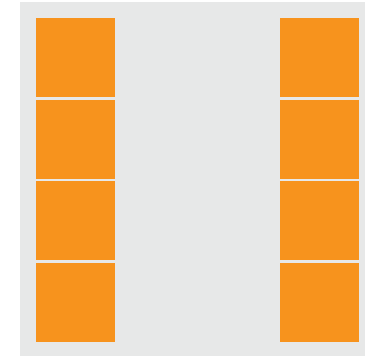

Arrangement in two rows

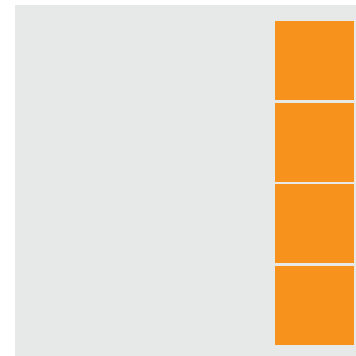

Arrangement in one row

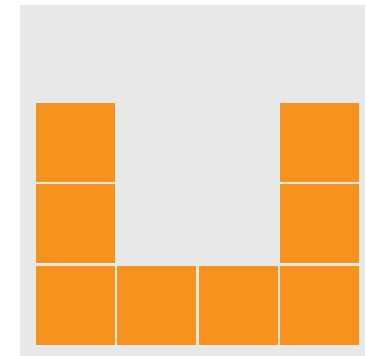

U type arrangement

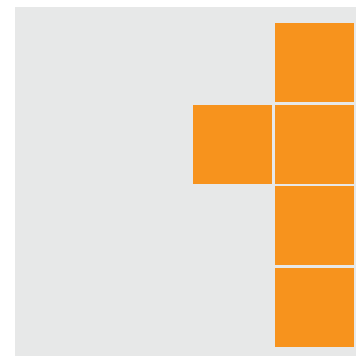

Peninsula-shaped kitchen

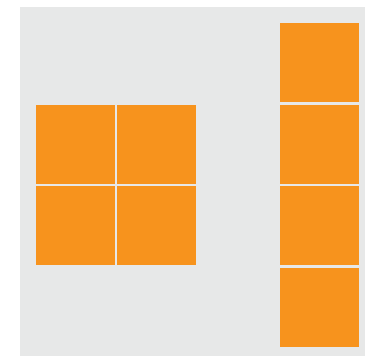

Kitchen with island

5 kitchen zones

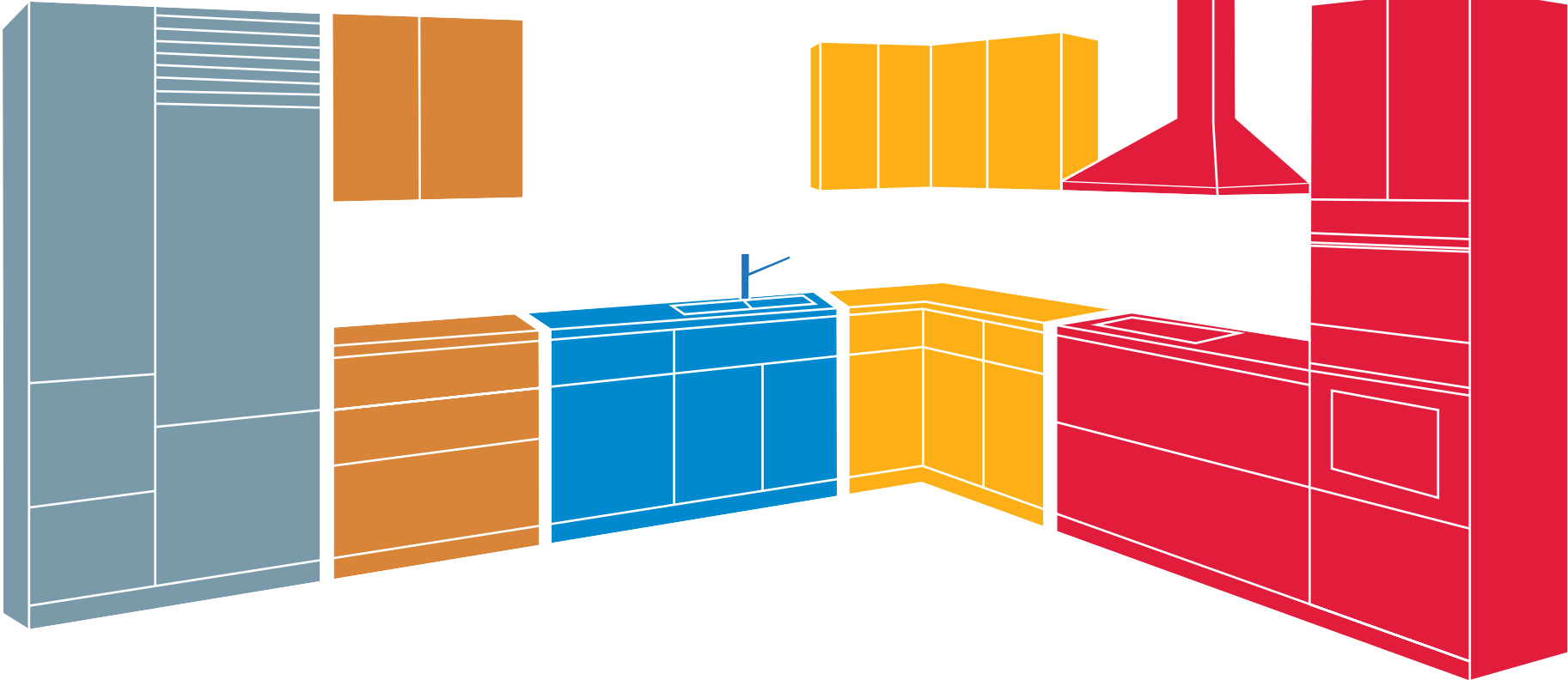

■ Product storage

■ Dish storage

■ Product / dish washing

■ Product processing / preparation

■ Cooking



Practical kitchen principles

A very good and thoughtful workflow, adequate and useable space, as well as excellent quality movement are the most important characteristics of a kitchen. If you pay attention to it, the kitchen will fully meet all the needs and its operation will be particularly comfortable and dynamic.



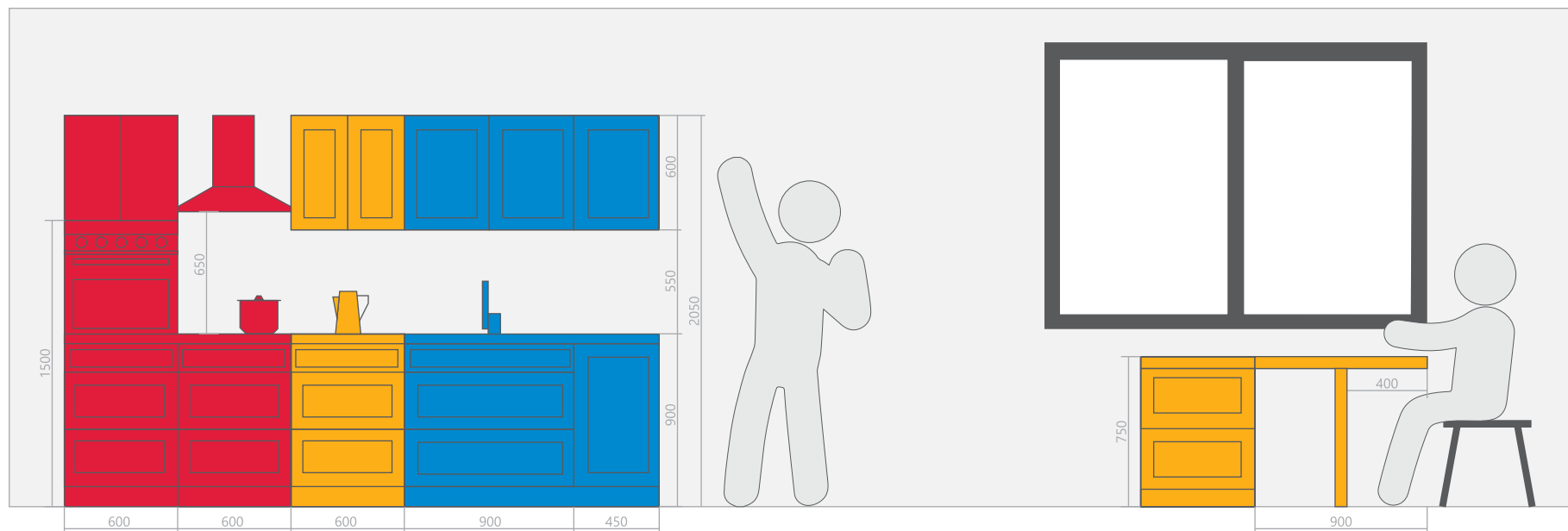

- Product and dish wash - dishwasher and tools, cleaner and tools, shredder, garbage can, garbage bags, holding bags, towels etc.
- Product preparing and processing - cutting boards, knives, meat hammer, grater, kitchen tools, food processor, juicer, coffee, tea, sugar, spices etc.
- Cooking and warming up - frying pans, boilers, heat-resistant utensils for ovens, foil, heat-resistant gloves etc.
- Dish storage - dishes, table tools, glasses etc.
- Product storage - frozen products, finished products, conned food, groceries, sweets, nuts, flakes etc.



Ergonomic kitchen planning

Preparing food and cleaning are repetitive workflows, therefore it is essential to make it as pleasant as possible and, by having ergonomic solutions, it will easily reduce the number of activities in the kitchen. This way everything is right at your fingertips. Kitchen layout depends on individual habits. If there is not much time in the mornings, it is good, if everything you need for breakfast, is easily reachable. The kitchen can be divided into five zones depending on the activities needed to be done (see page 25). This minimizes distances and ensures that all objects are exactly where they should be. Cooking is comfortable and pleasant when everything is ready available. It is also perfectly complemented by full drawers with practical internal dividers that organize content and provide clear transparency.





blum

Rational movements not only speed up work, but also make it much more comfortable and less tiring.

Optimal use of kitchen

There is no such a thing as too many useful places. There are countless different ways to use the room at its greatest potential, however it must be taken into account that the professional result also requires professional vision. The amount of kitchen space depends on the number of family members, shopping and cooking habits. When planning a kitchen, it should be considered that the kitchen is a long-term investment, it usually serves for about 15 years or more. Optimal use of available space for use is possible with wider, higher and deeper drawers and shelves. It is simple and effective. Innovative solutions and new inventions create a new, usable space - without changing the size of the room.

3 useful suggestions

1. We recommend you use one wide pull-out shelf instead of two narrow places. This way you can get up to 15 % more useful space.
2. Higher pull-out shelves with enclosed side edges allow you to use each centimetre. Its items can be placed much more conveniently and get up to 55 % more space.
3. If possible, use deeper pull-out shelves. This way you save up to 30 % more space.



- Product storage: side by side fridge, freezer, bread box, kitchen units with shelves, drawers.
- Product and dish wash: built-in dishwasher, dish rack, sink (easy to use with depth >160 mm), faucet (easy to use with a pull-out shower).
- Dish storage: kitchen units with shelves, drawers.
- Product preparing and processing: recommended minimum width for work surface >1500 mm, recommended height 150 mm under the bent arm at 90°angle, drawers (for a better content review and more convenient insertion / removal of accessories).
- Cooking and warming up.
- Food intake: necessary space for feet under table surface 350 - 400 mm and maneuvering zone diameter 600 mm.

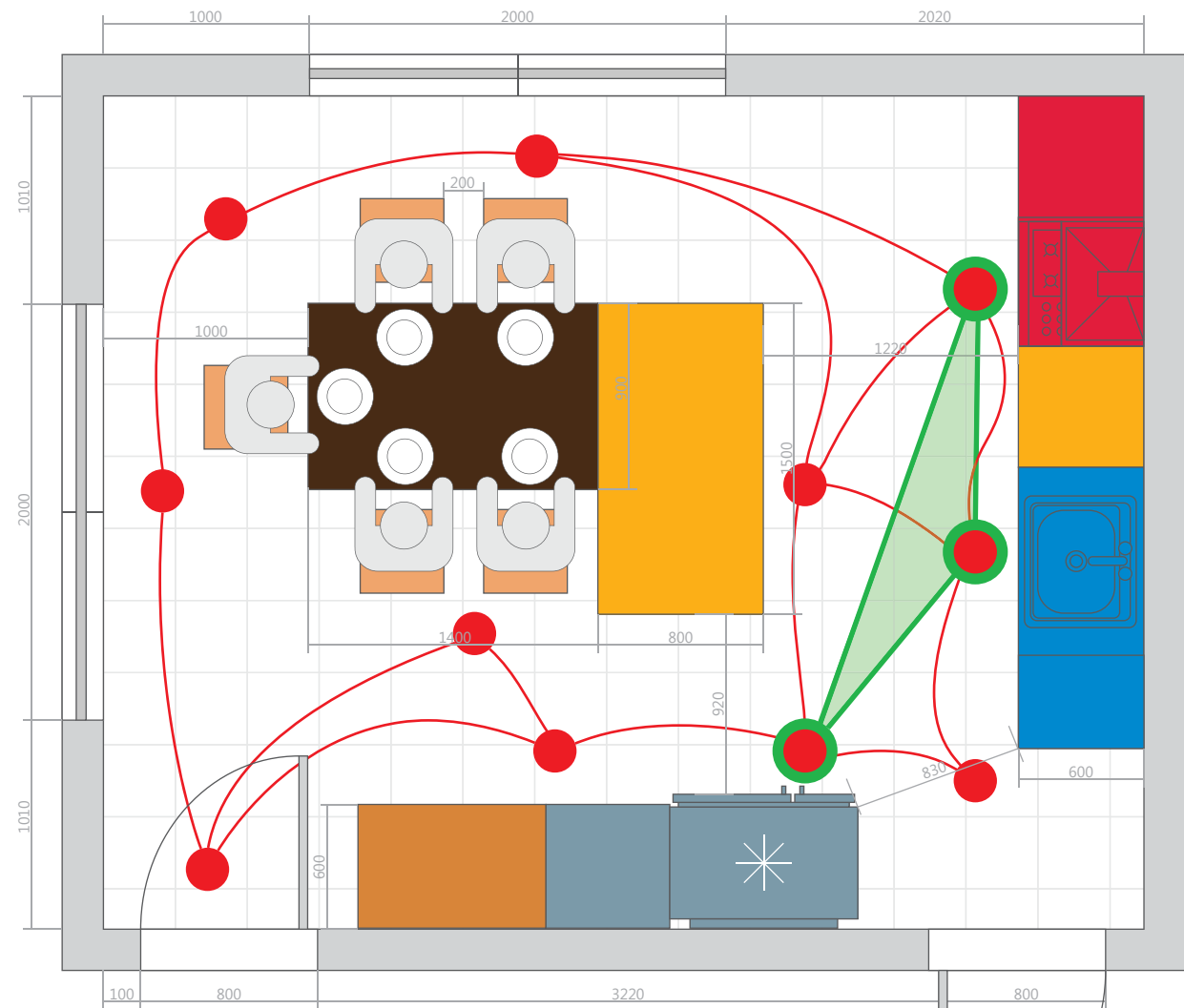

● Motion direction: minimum width of the aisle 500 - 600 mm, maneuvering zone diameter - 600 mm

⊙ Work triangle

User friendly motion in kitchen

You need to feel comfortable in the kitchen. In a beautiful and practical kitchen, the furniture must open easily and comfortably, move smoothly and gracefully, even the loaded movement is quiet and effortless. High quality fittings, combined with excellent equipment, provide the user with great added value - comfort and thoughtful motion in the kitchen. Every detail is important, when planning a new kitchen, as they form a single set of furniture, that will last many years. Motion technologies - the silent closing feature ensures that the closing the furniture will be quiet and effortless. In addition, the mechanical and electrical opening system helps open the furniture without handles.





Facade: MDF, colour NCS S8000-N

Handle: RO 049-160

Worktop: artificial stone, snow white 033A

Every solution is unique as RIPO offers a wide range of varied kitchens.

Kitchen cabinets

The ease use of kitchen cabinets is dominantly determined by the used fittings: drawer and lifting mechanisms, hooks and handles. RIPO kitchen cabinets are manufactured using the leading European fitting manufacturers (Blum, EGGER, Kesseböhmer, Hafele, Italiana Ferramenta, etc.). The fittings used are both elegant and visually appealing and very well suited for everyday use and comfort. The available opening mechanisms (hinges, drawers) are available with the silent closing principle, they have the Softstop function. Drawers have a full outline. In turn, the handles are available in both classic - screwdrivers and various moulded or flow-type handles.



Base units

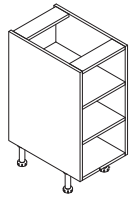

open shelf unit, 2 shelves
W 150-900, H 720, D 580

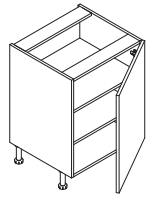

1 door, 2 shelves
W 300-600, H 720, D 580

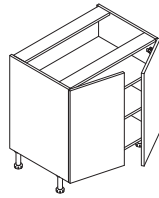

open shelf cabinet, 2 shelves
W 600-1000, H 720, D 580

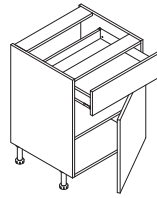

1 drawer, 1 door, 1 shelf
W 300-600, H 720, D 580

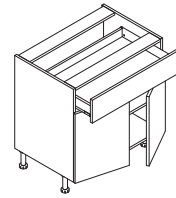

1 drawer, 1 door, 1 shelf
W 600-900, H 720, D 580

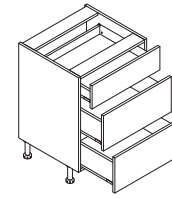

1 shallow drawer,
2 deep drawers
W 300-1000, H 720, D 580

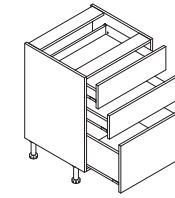

2 shallow drawers,
1 deep drawer
W 300-1000, H 720, D 580

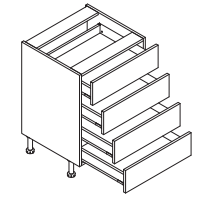

4 shallow drawers
W 300-1000, H 720, D 580

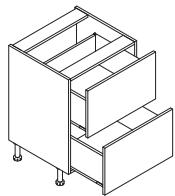

4 deep drawers
W 300-1000, H 720, D 580

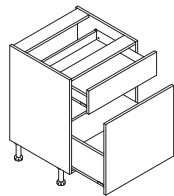

1 shallow drawer,
1 deep drawer
W 300-1000, H 720, D 580

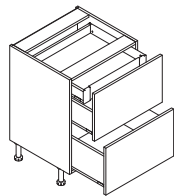

1 shallow drawer,
2 deep drawers
W 300-1000, H 720, D 580

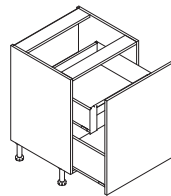

1 shallow drawer,
1 deep drawer
W 300-1000, H 720, D 580

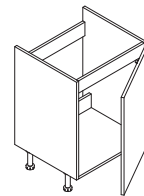

for sink, 1 door
W 450-600, H 720, D 580

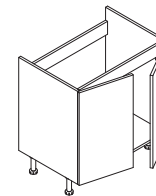

for sink, 2 doors
W 600-1000, H 720, D 580

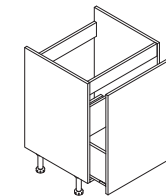

for sink, 1 door
W 450-600, H 720, D 580

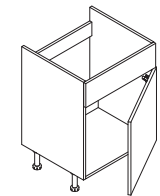

for sink, 1 door
W 450-600, H 720, D 580

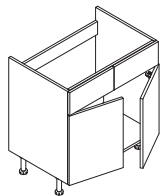

for sink, 2 door
W 600-1000, H 720, D 580

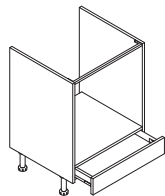

for built-in oven, 1 drawer
W 600, H 720, D 580

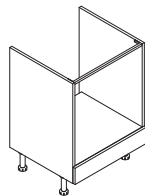

for built-in oven
W 600, H 720, D 580

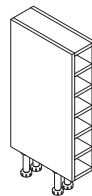

base unit bottle rack, 5 shelves
W 150, H 720, D 400

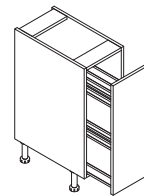

1 door, pull out, 2 baskets
W 200/300, H 720, D 580

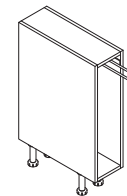

pull out, for towels
W 150, H 720, D 580

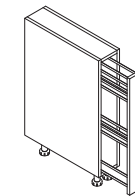

1 door, pull out, 2 baskets
W 150/200, H 720, D 544

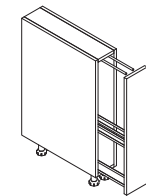

1 door, pull out, for towel
and basket
W 150/200, H 720, D 580

* base unit height dimensions without plinth
* all dimensions are in mm

Base corner units

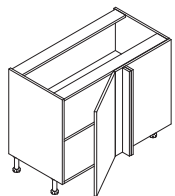

1 door, 1 shelf
W 1100-1250, H 870, D 670

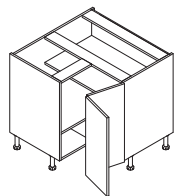

1 door, 1 shelf
W 800-900, H 870, D 800-900

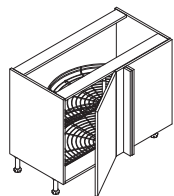

1 door, 2 revolving baskets
W 1100-1250, H 870, D 670

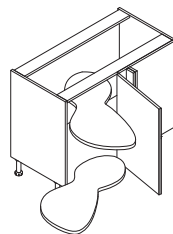

1 door, 2 pull-out Le Mans baskets
W 1100-1250, H 870, D 650

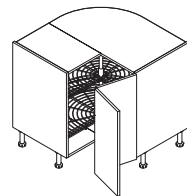

1 door, 2 revolving baskets
W 800-900, H 870, D 800-900

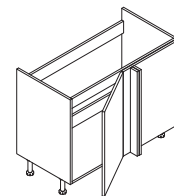

for sink, 1 door
W 1100-1250, H 870, D 650

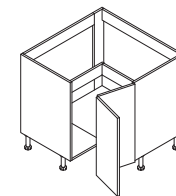

for sink, 1 door
W 800-900, H 870, D 800-900

Wall corner units

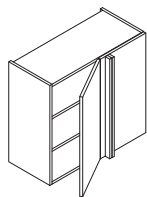

1 door, 2 shelves
W 700-1000, H 360-900, D 400

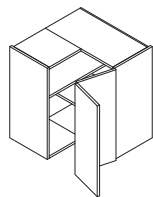

1 door, 2 shelves
W 650, H 540-900, D 650

* base unit height dimensions without plinth
* all dimensions are in mm

Tall units

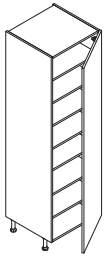

1 door, shelves
W 300-600, H 1080-2160, D 580

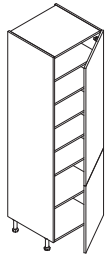

2 doors, shelves
W 300-600, H 1080-2160, D 580

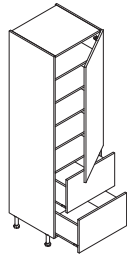

1 door, shelves, 2 drawers
W 300-600, H 1080-2160, D 580

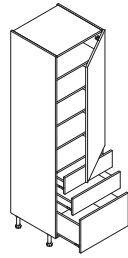

1 door, shelves, 3 drawers
W 300-600, H 1080-2160, D 580

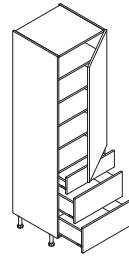

1 door, shelves, 3 drawers
W 300-600, H 1080-2160, D 580

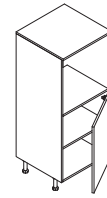

for oven, 1 door
W 600, H 1340, D 580

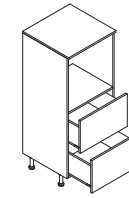

for oven, 2 drawers
W 600, H 1340, D 580

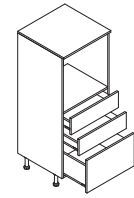

for oven, 3 drawers
W 600, H 1340, D 580

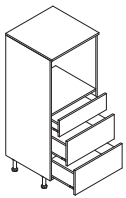

for oven, 3 drawers
W 600, H 1340, D 580

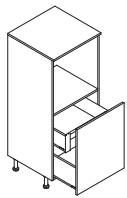

for oven, 2 drawers
W 600, H 1340, D 580

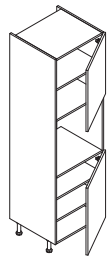

for oven, 2 doors
W 600, H 1800-2160, D 580

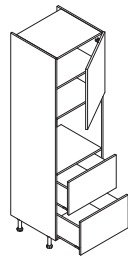

for oven, 1 door, 2 drawers
W 600, H 1800-2160, D 580

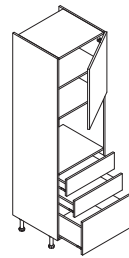

for oven, 1 door, 3 drawers
W 600, H 1800-2160, D 580

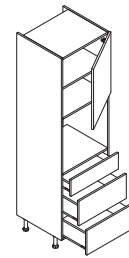

for oven, 1 door, 3 drawers
W 600, H 1800-2160, D 580

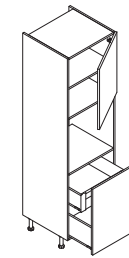

for oven, 1 door, 2 drawers
W 600, H 1800-2160, D 580

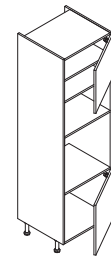

for oven and microwave, 2 doors
W 600, H 1800-2160, D 580

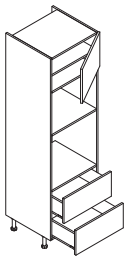

for oven and microwave,
1 door, 2 drawers
W 600, H 1800-2160, D 580

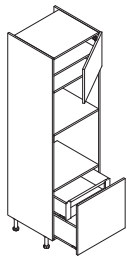

for oven and microwave,
1 door, 2 drawers
W 600, H 1800-2160, D 580

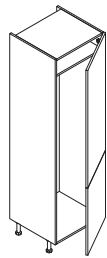

for refrigerator,
2 doors
W 600, H 1800-2160, D 580

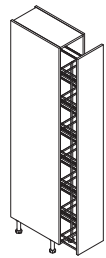

pull-out basket for food storage,
1 door,
W 300, H 1600-2160, D 580

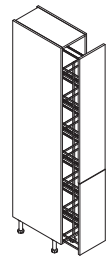

pull-out basket for food storage,
2 doors
W 300, H 1600-2160, D 580

* base unit height dimensions without plinth
* all dimensions are in mm

Wall units

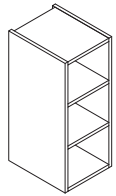

open unit, 2 shelves
W 150-900, H 360-900, D 360

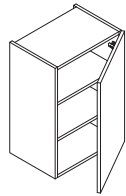

1 door, 1 shelf
W 300-600, H 360-900, D 360

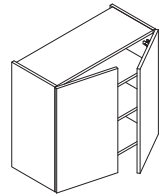

2 doors, 1 shelf
W 600-1000, H 360-900, D 360

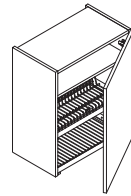

1 door, plate rack
W 450/600, H 540-900, D 360

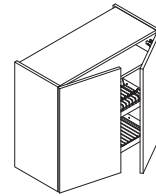

2 doors, plate rack
W 600/800/900, H 540-900, D 360

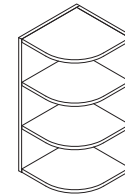

open corner unit, 2 shelves
W 250-300, H 360-900, D 360

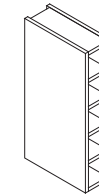

base unit bottle rack, 5 shelves
W 150, H 360-900, D 360

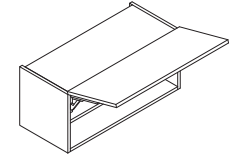

flap opening, 1 shelf
W 600-1000, H 360, D 360

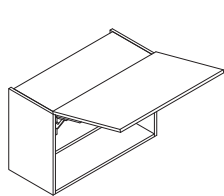

flap opening, 1 shelf
W 600-1000, H 560, D 360

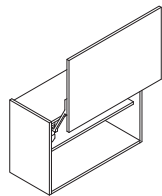

flap over door, 1 shelf
W 600-1200, H 360-560, D 360

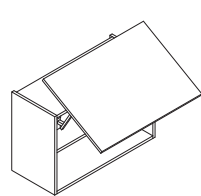

flap over door, 1 shelf
W 600-1200, H 560-720, D 360

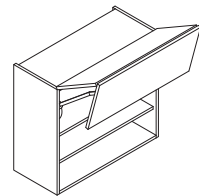

folding door, 1 shelf
W 600-1200, H 720-900, D 360

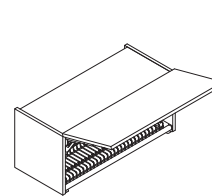

flap opening, plate rack
W 600/800/900, H 360, D 360

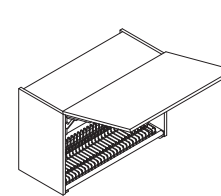

flap opening, plate rack
W 600/800/900, H 560, D 360

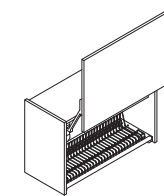

flap over door, plate rack
W 600/800/900, H 360-560, D 360

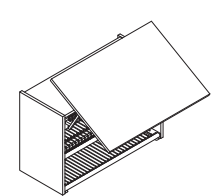

flap over door, plate rack
W 600/800/900, H 560-720, D 360

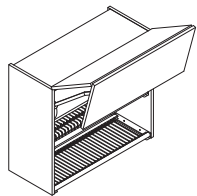

folding door, plate rack
W 600/800/900, H 720-900, D 360

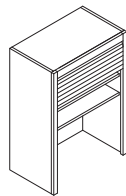

with rullo facade, 2 shelves
W 600/900, H 862-1402,
D 360/580

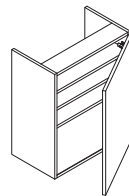

for hood, 1 door
W 600, H 500/680/860, D 360

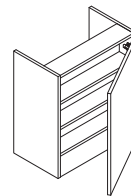

for hood, 1 door
W 600, H 500/680/860, D 360

* all dimensions are in mm



Glass panel with printing

Worktop: melamine, F283 ST22 Boston Concrete

Facade: acrylic, gray metallic 02.09

Kitchen Modern

Wall panels

The wall part between the floor and wall cabinets are exposed to continuous influence - cooking, food processing and washing dishes. As a result of all the above, the walls get dirty and exposed to different temperatures. As an alternative to wall tiles, wall panels of different materials can be used. Like wall tiles, they also have a decorative and functional meaning. Kitchen wall panels make the kitchen more practical for use and provide an attractive design solution.



Wall panel design

Wall panels are an attractive way to revive kitchen interior. This way you reduce tidying up in the kitchen. There are many different wall panel solutions, for example, transparent panels remain unchanged and protect existing walls from stains and dirt. In turn, the panels with pictures make entire kitchen uniquely decorated. Monochrome wall panels are also available. Thanks to the fact that the options for the design are limitless, the design of the wall panels is an expressive and complementary addition to everyone's taste in the kitchen.



See some examples on your right. ►

Glass wall panels

The choice of glass panels is a very practical option. Glass panels can be used in various decorative, coloured films or glass imprints with an optional image. Glass panels visually refreshes the kitchen and serves as a design element. These panels are heat-resistant and can be placed near the hob surface. The panels are easy to maintain and power sockets can be fitted into the glass.





Facade: aluminium frame, deco material, glass

Handle: RO 035

Worktop: melamine, F312 ST87 Ceramic Chalk



Kitchen Modern



Melamine panels

The melamine panel offers a wide range of wood imitation, textured and various colour tones. Melamine wall panels are an economical solution. However, these panels are non-durable and should not be placed close to direct fire.



Plastic wall panels

Plastic wall panels are made of HPL material. Possible solutions with a variety of decorative textures and a wide range of colour tones. These panels are moisture-proof, heat-resistant, easy to maintain and can easily integrate power sockets, if necessary.



Facade: melamine, H1180 ST37 Natural Halifax Oak

Facade: melamine, F186 ST9 Light Grey Chicago Concrete

Kitchen worktop plays an important role-both in design and in use.

Kitchen work surface

Premium quality work surfaces have a long operating life, as long as they are maintained and looked after properly. The work surface is the place, where the main work in the kitchen takes place. The products and dishes are made here. The work surface is in constant contact with various materials and food. It is subject to various loads and temperatures.

Work surfaces according to the type of materials and their mechanical strength can be divided into the following groups: melamine surfaces, natural stone surfaces, artificial stone surfaces, surfaces of other materials (metal, natural wood and similar).



Natural stone surfaces

Natural stone surfaces are tough and extremely durable. The stone looks great and brings luxury elegance in any interior. It has an asymmetrical pattern, a unique texture and design. Natural stone surfaces are made from various stone materials, but one of the most popular is granite. The benefits of these surfaces are things like unlimited design possibilities, high scratch and heat resistance, acid resistance etc. Natural stone surfaces are visually appealing. They come in different top coat i.e. polished, matte, rough. The material is easy to maintain, with a neutral environment.

Artificial stone surfaces

Artificial stone is a composite material consisting of artificial resins and natural minerals. This material is congeneric, solid and without pores. Often artificial stone surfaces are chosen of quartz composite material. Thanks to its visual appeal and technical properties, the material is widely used in the process of manufacturing kitchen surfaces. The advantages of artificial stone are the seamless joints, durability and hardness, the ability to repair and restore in its original appearance and structure, easy maintenance and cleaning, non-toxic, wide range of colours and tint. Artificial stone material has virtually no limitations and drawbacks, and the surfaces are very grateful for shaping, giving unlimited design possibilities.





Facade: melamine, H1486 ST36 Pasadena Pine

Laminate surfaces

Laminate is a widely used material, which is most often used to make the painted and textured colours, suitable for the work surface. The variety of offered laminate materials, makes possible to find the most suitable option and to create various furniture and interior elements. Material and its properties are suitable for use in the kitchen. Surface solution, like this, retains high performance properties even under large surface loads.



Kitchen furniture
equipment

Glass wall panel

Worktop: melamine, W1000 ST2 White

Facade: acrylic, white 02.01



Lifting mechanisms, hinge systems

RIPO offers a variety of Blum lifting mechanisms, that make the operation of kitchen furniture easy, comfortable and enjoyable, and the attractive design fits into a wide range of options. The choice of lift mechanism is a long-term solution, so it needs to be thought through out and fit with the interior. The lifting mechanisms are as follows: the facade opens by folding in the middle, the facade can be lifted up or parallel to the body, the facade can be lifted upwards in 90 degrees etc.

Furthermore, the hinges in the system combines innovative technology and movement comfort. The wide range of hinges offered by Blum with built-in motion technology allows you to find the perfect solution for almost any facade. Each facade is closed and opened elegantly, silently and effortlessly.



RIPO kitchen furniture uses products from the Blum brand, which are functionally well thought out, their design is rewarded and they are durable.

blum



Motion elegance is important.

Drawer and guide systems

Drawer systems are an excellent combination of design and technology that adds to it. The offer provides a wide range of applications. Opening and closing does not require any effort; it works by touch. These are solutions that have gained worldwide recognition. RIPO track systems are a real evolution of movement. Un-beaten track action that is easy, practical and versatile. Access control systems that fit all tastes and intentions. It is important to feel good with every product and its features.



Types of motion technologies:
BLUMOTION, TIP-ON BLUMOTION, SERVO-DRIVE



RIPO offered equipment enhances the user's comfort in the kitchen.



Internal separator systems and motion technology

RIPO offers a range of design solutions for furniture without handles in all living areas, including the kitchen. Motion technology makes the use of furniture comfortable and ergonomic, especially since the opening is so easy and gives the user a pleasant adventure. In order for lifting mechanisms, doors and drawers to open, as if they were on their own, a slight touch of the hand, hip or knee is sufficient. Any living space has the right solution - electric, mechanical or combined. Convenient adjustment helps to create a harmonious overall look. Many components can be assembled without tools. It takes very little time to create a precise and consistently smooth line spacing.



High quality handles for long and carefree life.



Handles

RIPO handles feature a collection of world-renowned manufacturers of handles. They are distinguished by their modern design, excellent functionality, high quality and latest technological solutions, that fit the wide range of user preferences and features, as well as convenience. RIPO offers handles in both: classic - screwdrivers and various moulded or flow-type handles.



Facade: natural oak, veneered 05.92



Kitchen Integra

Flow handles

Nowadays it is more common to have kitchen furniture with flow handles. This elegant solution creates an appealing, spacious and harmonious kitchen design. The design trends evolve to enhance the comfort, simplicity, practicality and look truly appealing. Flow handle design trends reflect in look and everyday application. It is worthwhile to go with the new trends not only in the technologies, but also in the furniture design trends to make everyday life more enjoyable and save our precious time on daily basis.





Facade: melamine, acacia 02.19

Glass wall panel

Facade: melamine, cappucino glossy 02.67

Kitchen Modern

Modern home appliances are like a companion in the kitchen.

Home appliances

Nowadays, the kitchen is not imaginable without modern home appliances. The latest technical equipment is more energy-efficient, capable and versatile, both in terms of functionality and design choices compared to previous generations of household appliances. Good home appliances greatly simplifies work in the kitchen and saves time. The kitchen appliances will certainly look better, if they have a unified design.

When designing and choosing a kitchen furniture, it must be co-ordinated with household appliances at the same time. It is not advisable to order furniture, if it is not known what the technology will be, otherwise serious difficulties may arise. In the constant technological evolution, more and more choices are made in favour of embedded household appliances. The design of this solution is more attractive and saves space in the room. It is important to install a built-in technology for fitting kitchen furniture. If, however, it is not possible to buy one of the built-in household appliances immediately, then a particular model should be selected and installed. There is no doubt that the range of home appliances available on the market is very wide. Experts in the industry can always help to avoid duplication of models, functionality of the equipment and price range.





RIPO visualises your ideas using modern design programmes and tools.

Designing

RIPO furniture and interior showrooms offer a wide range of information on kitchens, materials and furniture. An extensive range of materials, tones, technologies and production capabilities make it possible to realize a wide range of ideas. RIPO team includes industry professionals - production craftsman, constructors, engineers, designers and furniture development specialists. Experienced designers give advice on realizing ideas and wishes, so that the final result meets the customer's taste and desired results. RIPO designers, providing consultation throughout the process, will result in space, where you can spend your time with the family and prepare delightful meals.

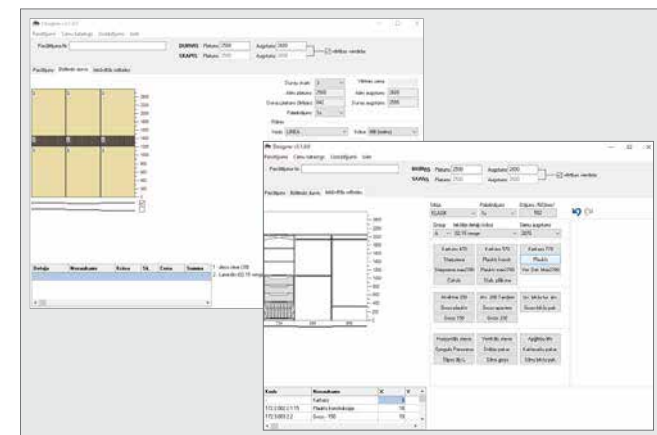
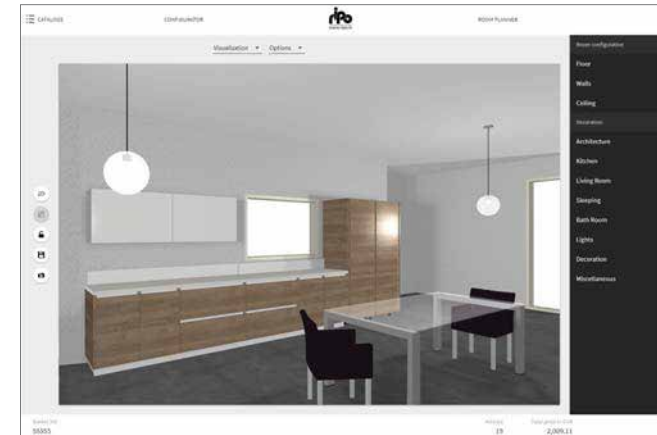



Modern manufacturing equipment guarantees high precision.

Manufacturing

RIPO kitchens are made according to the customers wishes, ideas and desires. The company owns a complete cycle of furniture manufacturing, which includes automated design and production of furniture. Application of modern technologies ensures the sustainable development of the production process. RIPO technology and materials base provides top quality, excellent design and functionality.

Delivery and assembly

RIPO offers delivery and assembly. This is a guarantee that the product will be delivered at a specific time and installation will not cause concern. The installation of the furniture on the site is in accordance with the manufacturer's technical drawings and specifications, which are harmonized during the design process. Household appliances are also offered for the installation of additional furniture, if all communication leads are correctly arranged and appropriate for the project. This saves time and resources required for organizing delivery of goods.





Facade: acrylic, white 02.01

Glass wall panel

Handle: RO 035

Tips from RIPO

ERGONOMICS

If the kitchen is arranged, with proper ergonomics, it will certainly be easier to work and cook. This means that when planning the kitchen, it should be guided by the principle of the proven location of the cases: refrigerator, sink, stove. Those who mainly work with right arm should be arranged in clockwise direction, while the left handed are opposite.

LIGHTING

Lighting in the kitchen is important because all activities must be transparent. Design trends are increasingly focusing on LED or spot lighting. If the kitchen is designed for hanging cabinets, then they can be lit up at the front and at the back, making the work surface especially bright and pleasant. Drawers can also be lit up, in which the content will be well-reviewed.

MATERIALS FOR SURFACES

Good working surfaces are those that will last long, but there is no surface that cannot be damaged. In this regard, a lot depends on the habits and care of keeping and maintaining the surface. It is important to keep the surface dry and remember that dirt around the sink and hot surfaces cannot be cleaned with sharp cleaning products.

COLOURS

The colour bouquet in the kitchen, of course, is a matter of taste, but the tone also has a practical meaning. For example, different surfaces and dirt will appear on light surfaces, while dust, fingerprints and fats will be seen better on dark surfaces.

FOOD ZONE

If there is no place for a family table in the closed or open kitchen, a good alternative is the counter with some chairs. This is an option to prepare a meal, while comfortably sitting down. Such a counter is a substitute for a kitchen island, where it is equally easy to cook and to bring a family together for a meal.

Handle: RO049-160

Facade: MDF, colour NCS S2002-Y50R

Worktop: artificial stone, platinum

Kitchen Classic

Tips from RIPO

LIFESTYLE

There is a need for a clear vision of the function that the kitchen will fulfil - whether it is to host guests, intensive cooking, chilling area etc. If it is expected that the kitchen will be used rarely, then it is possible to do without a variety of additional equipment, which nevertheless is an integral part of kitchen enthusiasts and households.

FAMILY

The number of people in the family is a factor to consider when planning a kitchen. The layout of the room is also affected by the number. When there are small children in the family, special attention should be paid to creating a safe environment, and it is also advisable to choose materials that are easier to maintain.

THE KITCHEN AREA

If the kitchen area is small, then the furniture and their layout should be chosen very wisely to leave as much free space as possible. The kitchen should be a safe place where everything is thoughtfully arranged. The planning should be based on workflows. Everything should be handy. The refrigerator is followed by a sink, then the work surface, then the stove, and then a shelf next to or under the table for serving dishes. It is sometimes enough to provide with basic kitchen functions and equipment, a very small area.

PRODUCTION TIME

Each project is individual and the kitchen furniture is affected by many aspects, that being said, on average, it takes approximately 6 weeks from the day the contract is signed. The production time may vary depending on the complexity of the project, the selected materials, equipment etc.

BENEFITS

RIPO kitchens reflect the traditional values that are realized in a modern interpretation and always open up new horizons in design, functionality and technology.

Facade: melamine, graphite 02.21

Facade: melamine, oak tranche 02.55

Worktop: melamine, Anthracite Vercelli Granite F028 ST89

Kitchen Integra

Tips from RIPO

KITCHEN CABINETS

The upper kitchen cabinets should not be placed too high so that you can easily access them. The upper cabinets should be shallower than the bottom ones, to prevent the risk of accidental injury. That being said, the lower cabinets can be deeper and fitted with large pull-out drawers. The bottom drawers usually hold the items we use very rarely, so you do not have to bend down too much.

WORKING SURFACE

It is most convenient to handle products at a height that is 5 cm lower than the user's elbow's bent position - an average of 90 cm above the floor. Too high or low working surface may cause some inconvenience. The average working surface width required to reach an entire surface which is approximately 60 - 70 cm. For the work surface, the most suitable place in the kitchen layout is between the sink and the stove (recommended at least 90 cm).

TABLE

When a person has a meal, he takes at least 60 cm from the table space. On the other hand, if people are sitting opposite each other, the table width should be at least 80 cm. The minimum distance from the work surface and the closets to the table is 100 cm, so that you can comfortably slide your chair and take the necessary items or do the necessary action. The average dining table height is 75 cm.

STOVE AND OVEN

The most comfortable position to use an oven is when it is placed at the belt height, however, in kitchens with a small area it is more advantageous to place the oven under the stove, so that cooking takes place in a compact and ergonomic room. It is important to tailor the kitchen to people rather than people to kitchen.

HOUSEHOLD ELECTRICAL DEVICES

For small electrical appliances that are used on a daily basis, it is advisable to provide an easily accessible place on the work surface or shelves near the wall sockets. Such a solution means that, for example, toaster or blender does not need to be unpacked and assembled at each use, and then disassembled again.

Contacts:

Matison Enterprise AB
Hammarby Sjöstad
Ljusslingan 4,
120 31 Stockholm
+46 72 331 4157

info@matison.se
www.matison.se

